

## CAR: USING JOBAN EXPRESSWAY

Take the Joban Expressway to Sakura Tsuchiura Interchange. Go left towards Tsukuba. At the second intersection (called "Sasagi"), turn right. At the third intersection (called "Namiki 2-chome"), turn left.

## TRAIN: USING TSUKUBA EXPRESS

Take the express train from Akihabara (45 min) and get off at Tsukuba Station. Take exit A3.

- (1) Take the Kanto Tetsudo bus going to "Arakawaoki (West Entrance) via Namiki", "South Loop-line via Tsukuba Uchu Center" or "Sakura New Town" from platform #4 at Tsukuba Bus Terminal. Get off at Namiki 2-chome. Walk for approximately 3 minutes to AIST Tsukuba Central.
- (2) Take a free AIST shuttle bus. Several NIMS shuttle buses go to AIST Tsukuba Central via NIMS and AIST Tsukuba East and you may take the buses at the same bus stop.  
Please note that the shuttle buses are small vehicles and they may not be able to carry all visitors.

## AIST Shuttlebus Schedule

Tsukuba Station	7:45	8:00	8:25	8:45	9:18	9:37(nb)	9:53	10:22	10:37(nb)	10:53	11:22	11:53
AIST Central	8:00(E)	8:22(W)	8:40(E)	9:07(W)	9:33(E)	10:00(N/E)	10:15(W)	10:45(N/E)	11:00(N/E)	11:15(W)	11:45(N/E)	12:15(W)
Tsukuba Station	13:22	13:32(nb)	13:53	14:22	14:53	15:22	15:53	16:15	16:50	17:12		
AIST Central	13:45(N/E)	13:55(N/E)	14:15(W)	14:45(N/E)	15:15(W)	15:37(E)	16:15(W)	16:30(E)	17:12(W)	17:27(E)		

Note: Buses (E) go to AIST Tsukuba Central via AIST Tsukuba East. Buses (W) go to AIST Tsukuba Central via AIST Tsukuba West. Buses (N/E) go to AIST Tsukuba Central via NIMS and AIST Tsukuba East. Letters "nb" denotes "the NIMS shuttle bus".

- (3) Take a taxi from Tsukuba Station to AIST Tsukuba Central. It should take approximately 15 minutes.

## TRAIN: USING JR JOBAN LINE

Take the train from Ueno (60 min) and get off at Arakawaoki Station. Take the West exit.

- (1) Take the Kanto Tetsudo bus going to "Tsukuba Daigaku Chuo" or "Tsukuba Center via Namiki" from platform #4 at Arakawaoki Station. Get off at Namiki 2-chome. Walk for approximately 3 minutes to AIST Tsukuba Central.
- (2) Take a taxi from Arakawaoki Station to AIST Tsukuba Central. It should take approximately 15 minutes.

## BUS: USING HIGHWAY BUSES

Take the JR or Kanto Tetsudo highway bus going to "Tsukuba Center" from Yaesu Minami Exit at Tokyo Station. Get off at Namiki 2-chome. Walk for approximately 3 minutes to AIST Tsukuba Central. It will take approximately 65 minutes (depending on traffic conditions) and it will cost 1180 yen for a one-way ticket.

## BUS: USING AIRPORT BUSES

Tsukuba Center - Haneda Airport: Costs 1850 yen one way, takes approximately 120 minutes

Tsukuba Center - Narita Airport: Costs 2600 yen one way, takes approximately 70 minutes

Tsukuba Center - Ibaraki Airport: Costs 1030 yen one way, takes approximately 60 minutes

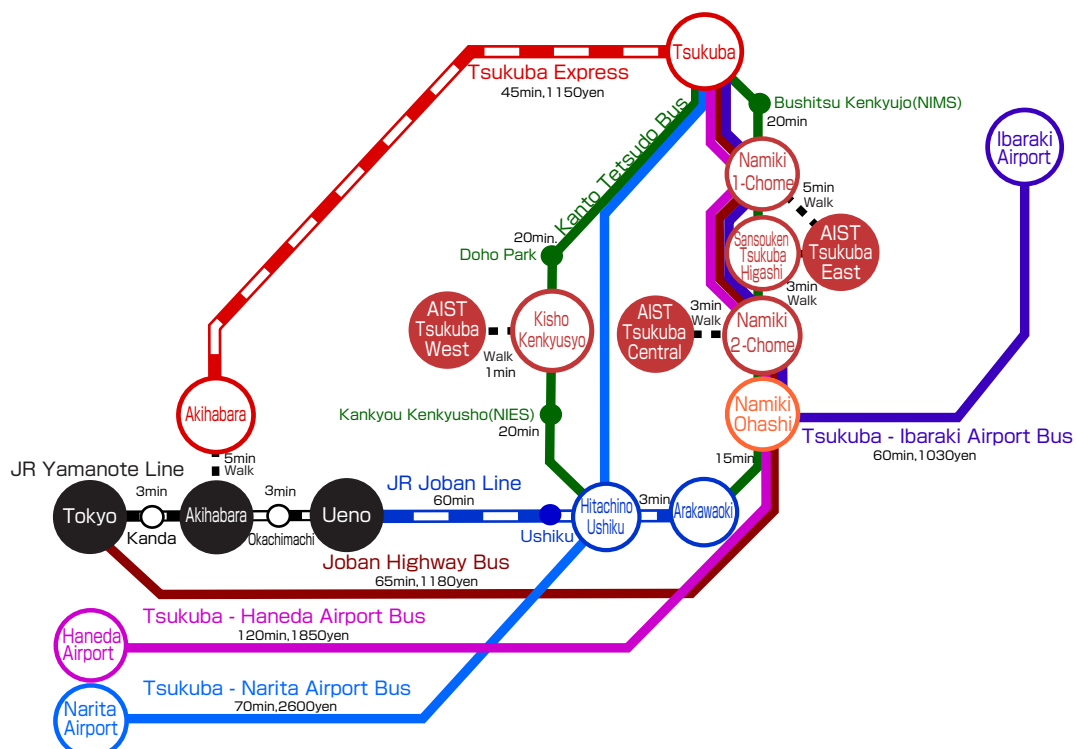

# AIST Tsukuba center access map

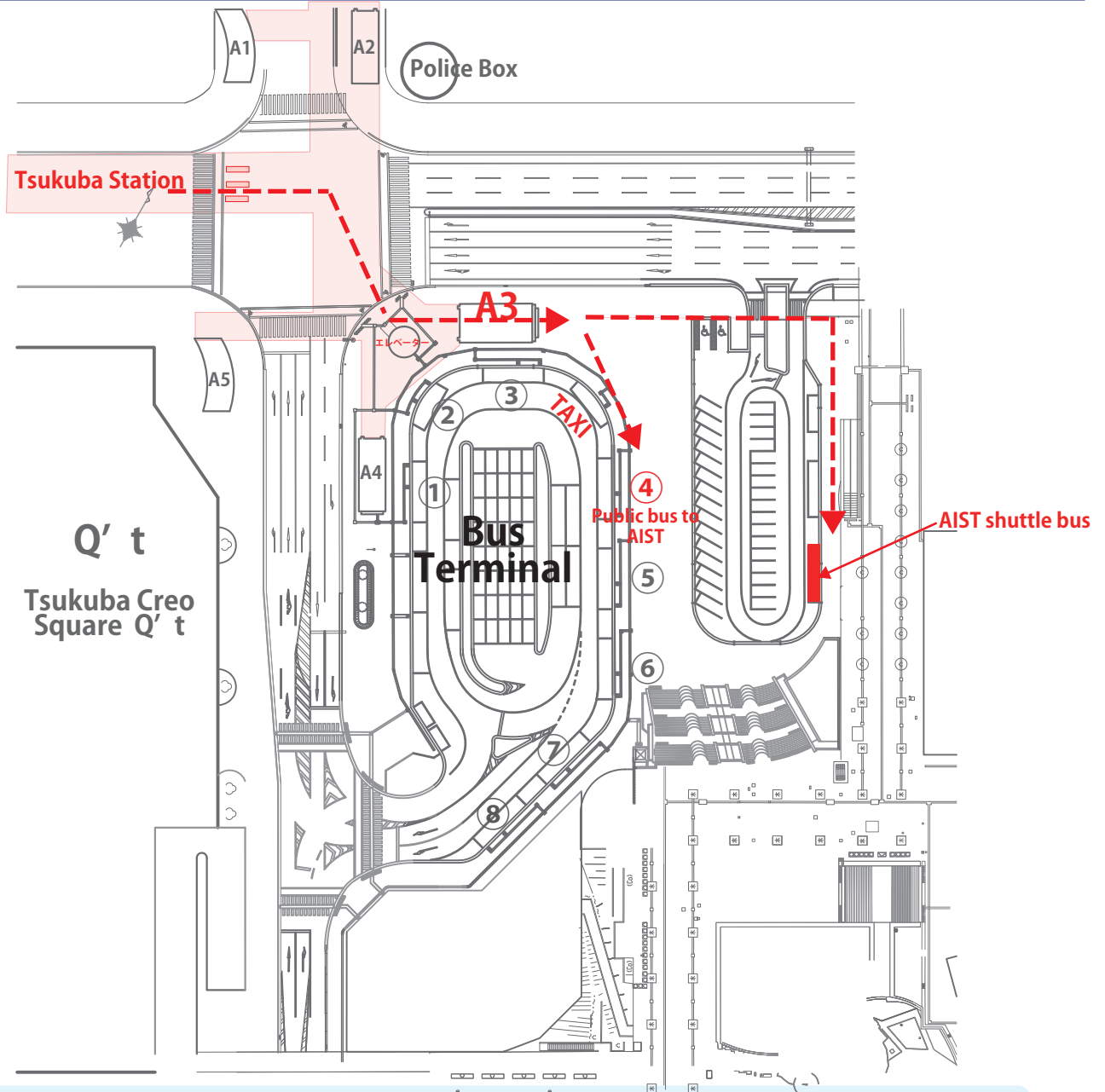

Logo marks on the AIST/NIMS shuttle buses



- \* When you take a shuttle bus, please make sure that the logo mark of AIST or NIMS (shown above) is on the side of the shuttle bus.
- \* Several NIMS shuttle buses go to AIST Tsukuba Central via NIMS and AIST Tsukuba East.
- \* The shuttle buses are small vehicles and they may not be able to carry all visitors.
- \* The shuttle buses are not operated on Saturdays, Sundays, and holidays.